

FERCHER flue gas heatexchanger type **FW-1000-X2** - Datasheet

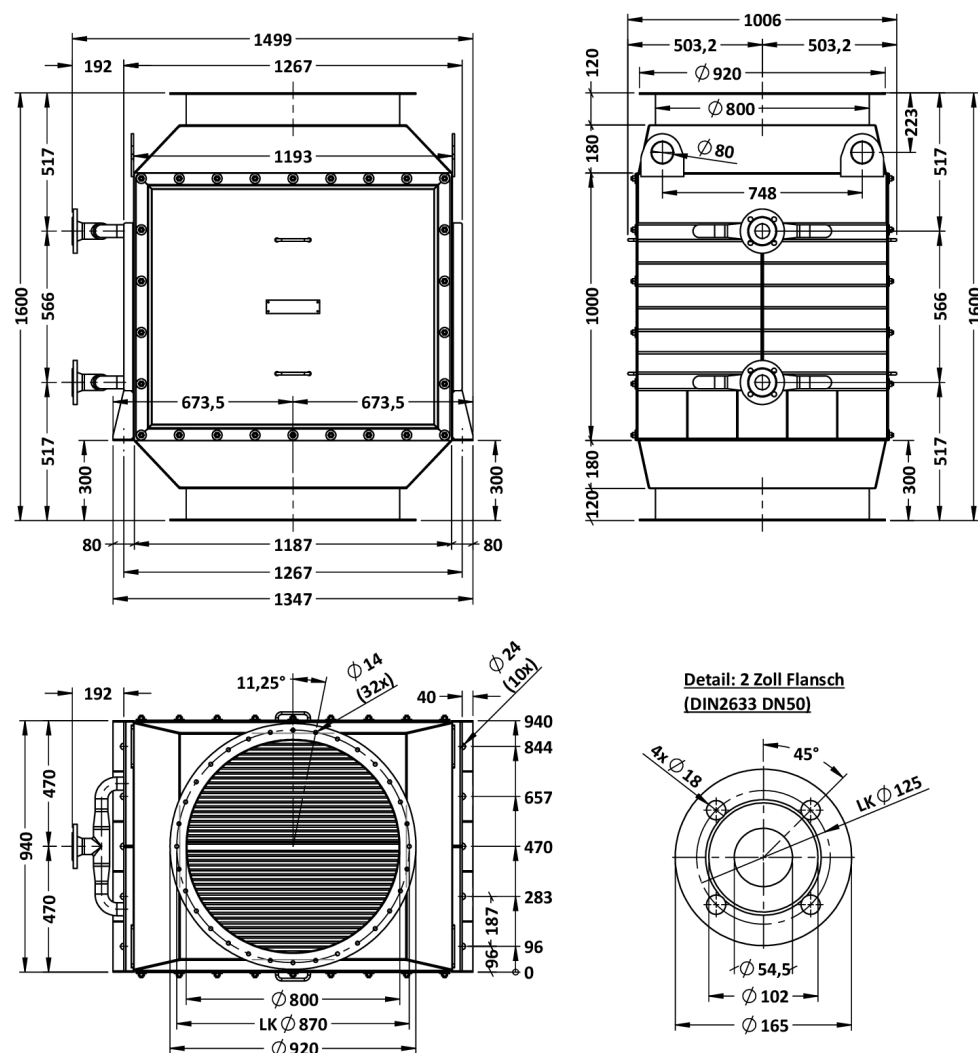

General		Flue gas	
Model-name / Type:	FW-1000-X2	Maximum-Flowrate:	26 000 m³/h
Construction-Type:	Fully welded	Max. allowed temperature:	500 °C
Material:	AISI 316Ti AISI 316L	Max. allowed pressure:	3 000 Pa (30 mBar)
		Flue gas-Inlet:	flange DN80
		Flue gas-Outlet:	flange DN80
External Dimensions		Heating-Water	
Length:	1 499 mm	Nominal-Flowrate:	5,2 L/s
Width:	1 006 mm	Max. allowed temperature:	110,0 °C
Height:	1 600 mm	Max. allowed pressure:	6 bar
Weights		Heating-Water inlet (DIN2633):	2 inch flange
Empty weight:	930 kg	Heating-Water outlet (DIN2633):	2 inch flange
Internal-Volume:	126 L		
Operating-Weight:	1 056 kg		

Cleaning: Manual cleaning (for instance with brush/pressure-cleaner/steam) is possible without disassembling the heat exchanger, just take off the panels (exhaust-gas flow must be off).

Exhaustgas-Connections: Included: 2 pcs. loose counter-flanges (for exhaustgas-connection) and 2 pcs. exhaustgas-flange-gaskets. Above mentioned weights include the weight for these counter-flanges and gaskets.

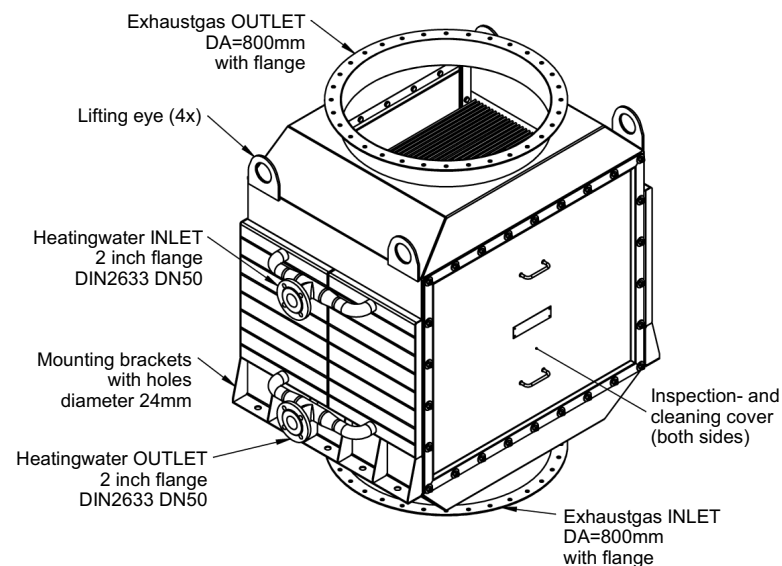



FERCHER flue gas heatexchanger type **FW-1000-X2** - Characteristic curves

Following characteristics are valid for the following operation (Exhaustgas from Gas/Oil-Burner) , Heatingwater-Temperature-IN: 60 °C, Volume-Flow: 5,2 L/s (=18,7 m³/h)

Heatingwater pressuredrop at 5,2 L/s Volume-Flow: 0,5 bar

Exhaust-gas flowrates are real volume flow rates, reference temperature is exhaust-gas IN temperature

For special/individual calculations please contact us at office@fercher.at. We gladly help you with choosing the correct heatexchanger and with calculations.

